

REVISIONS			
REV.	DESCRIPTION	DATE	APPROVED
REL-02	Added "EB" to Part Description	7/18/2017	R.L.J.

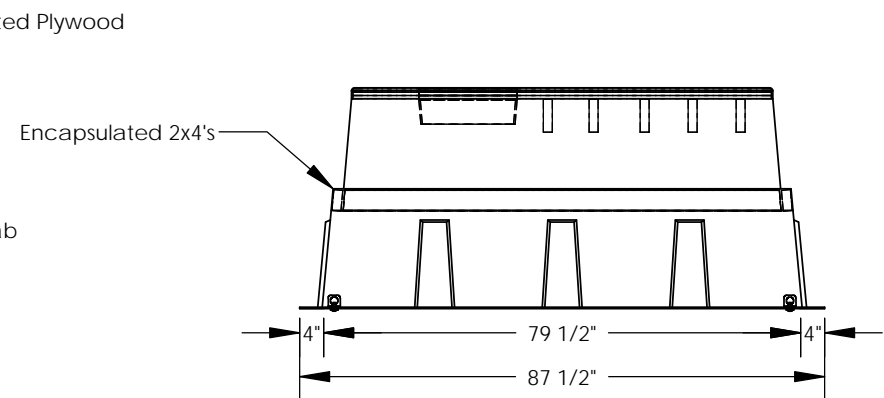
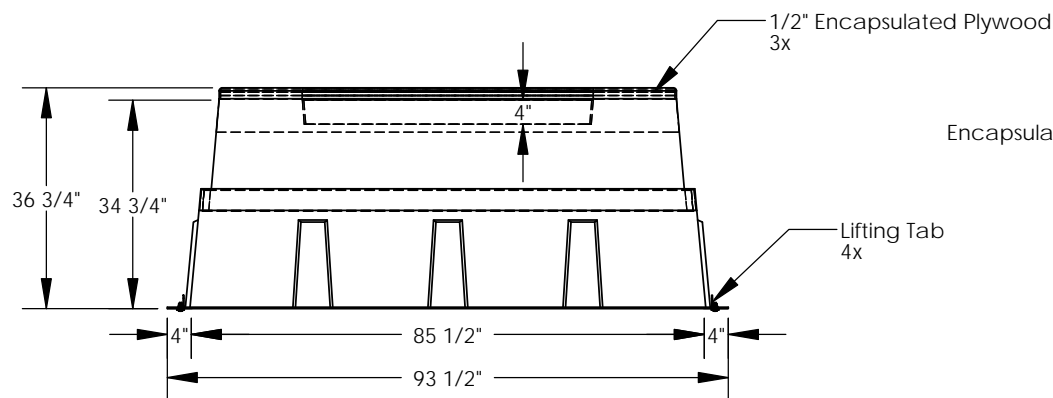
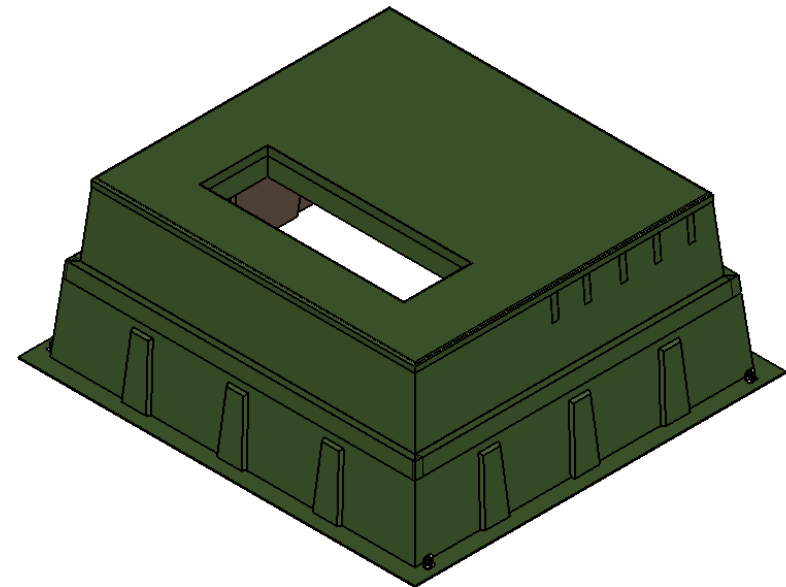
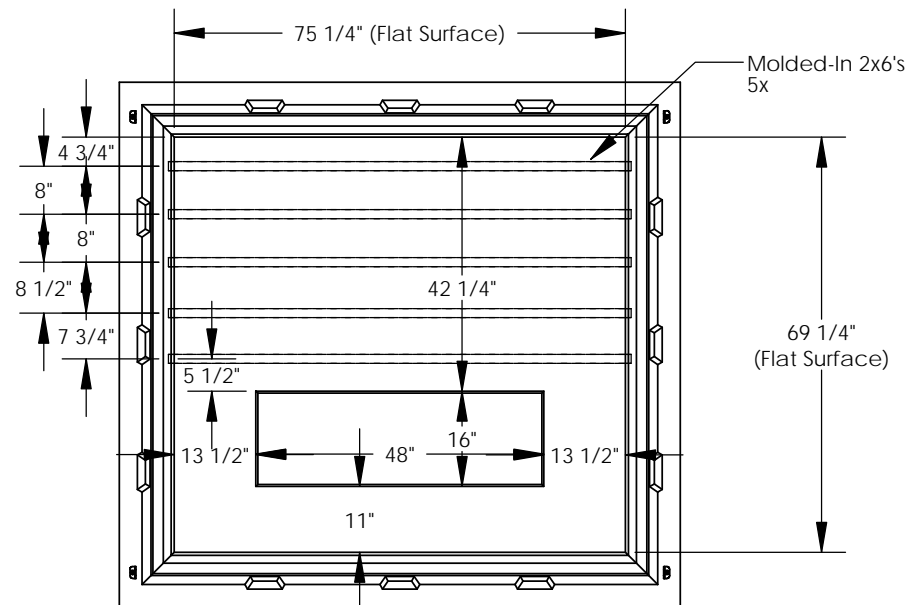

Proper installation of this box pad requires a concrete pad/footing to be poured underneath the box pad prior to installation.

PROPRIETARY AND CONFIDENTIAL
THE INFORMATION CONTAINED IN THIS DRAWING IS THE SOLE PROPERTY OF NORDIC FIBERGLASS, INC. ANY REPRODUCTION IN PART OR AS A WHOLE WITHOUT THE WRITTEN PERMISSION OF NORDIC FIBERGLASS, INC. IS PROHIBITED.

Customer Name: N/A		
DIMENSIONS ARE IN INCHES TOLERANCES: ANGLES $\pm 1^\circ$ FRACTIONAL $\pm 1/2$ ONE PLACE DECIMAL $\pm .060$ TWO PLACE DECIMAL $\pm .030$ THREE PLACE DECIMAL $\pm .015$		
MATERIAL		
DRAWN	NAME	DATE
CHECKED	M.F.K.	10/5/16

Nordic Fiberglass, Inc.		
21415 US Hwy 75 NW, Warren, MN 56762 www.nordicfiberglass.com 218-745-5095 ph. --- 218-745-4990 fax		
GS-75-69-36RT2-3X-EB-MG-48x16		
SIZE	ITEM ID:	REV.
A	01774.02	REL-02
SCALE:1:32	WEIGHT:	SHEET 1 OF 1